

**“Crankshaft pulley holding tool suitable for
OPEL 1.0/1.4
B10 / B14 engines”**

Rev.0 012020

FG 192/OP3B

RELATED TOOL:



FG 192/OP3A



WARNINGS



ALWAYS REFER TO THE VEHICLE MANUFACTURER'S INSTRUCTIONS AND TO THE MANUAL OF THE VEHICLE IN ORDER TO KNOW THE DATA AND PROCEDURES THAT YOU MUST USE. THIS DOCUMENT MUST BE USED ONLY FOR INFORMATION.



ALWAYS USE PROPER PROTECTIVE GLOVES



ALWAYS USE PROPER PROTECTIVE GLASSES



ATTENTION

The wrong timing or out of phase of the engine can result in a damage of the valves. The use of these timing tools is at solely discretion of the user and, the Fasangas Srl can not be held responsible for any damage to the engine caused by the use of these timing tools.

IMPORTANT SAFETY INSTRUCTIONS:

- ALWAYS disconnect the battery earth leads (before check the radio code if it's available)
- DO NOT turn crankshaft or camshaft with the timing belt/chain removed.
- Remove spark plugs to make the engine turn easier.
- ALWAYS turn the engine in the normal direction of rotation (unless otherwise stated).
- Mark the position of the crankshaft position sensor before disassembly (If it's supplied).
- NEVER turn the crankshaft via camshaft or other gears.
- ALWAYS observe all tightening torques.
- NEVER use cleaning fluids on belts, sprockets or rollers.

CONTENT: special tools

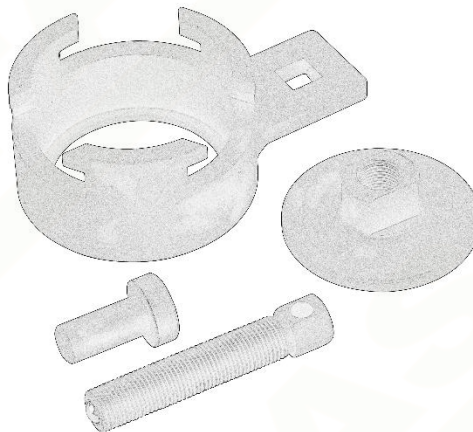

OEM CODE	DESCRIPTION / USE
EN-44226-1/2/3/5	Crankshaft pulley holding tool

APPLICATIONS

Opel/Vauxhall

MODEL	kW (hp) rpm	ENGINE CODE	ENGINE	
Astra-K (2015 – 2018)	110 (150) 5600	LE2/B14XFT	1,4 Turbo	P
Mokka X (2016 – 2018)	112 (152) 5600	LE2/B14XFT	1,4 Turbo	P
Karl (2015 – 2018)	53 (72) 6500	LWT/B10XL	1,0 LPG ecoFLEX	P
Karl Rocks (2016 – 2018)	54 (73) 6500	LWT/B10XL	1,0 LPG ecoFLEX	P
Karl (2015 – 2018)	55 (75) 6500	L5Q/B10XE	1,0	P
Karl (2016 – 2018)	55 (75) 6500	L5Q/B10XE	1,0 LPG ecoFLEX	P
Karl Rocks (2016 – 2018)	55 (75) 6500	L5Q/B10XE	1,0	P
Karl Rocks (2016 – 2018)	55 (75) 6500	L5Q/B10XE	1,0 ecoFLEX	P
Viva (2015 – 2018)	55 (75) 6500	L5Q/B10XE	1,0	P
Astra-K (2015 – 2018)	74 (101) 6000	LV7/B14XE	1,4	P
Astra-K (2015 – 2018)	92 (125) 5600	LE2/B14XFL	1,4 Turbo	P